

An aerial photograph of a densely packed slum. The buildings are tightly clustered together, with roofs in various colors including green, blue, red, and brown. The overall appearance is one of extreme density and informal construction. The text "MICRO ARCHITECTURE : DEVELOPMENT OF SLUM" is overlaid in white, underlined, serif font across the middle of the image.

MICRO ARCHITECTURE : DEVELOPMENT OF SLUM

# WHAT IS MICROARCHITECTURE?

An emerging design trend is filling the gap between furniture and architecture by shaping space through objects at the intersection of the two, creating a dynamic and highly adaptable environment.

Either a consequence of the increased demand for flexibility in small spaces or the architectural expression of a device-oriented society, elements in between architecture and furniture open the door towards an increased versatility of space.

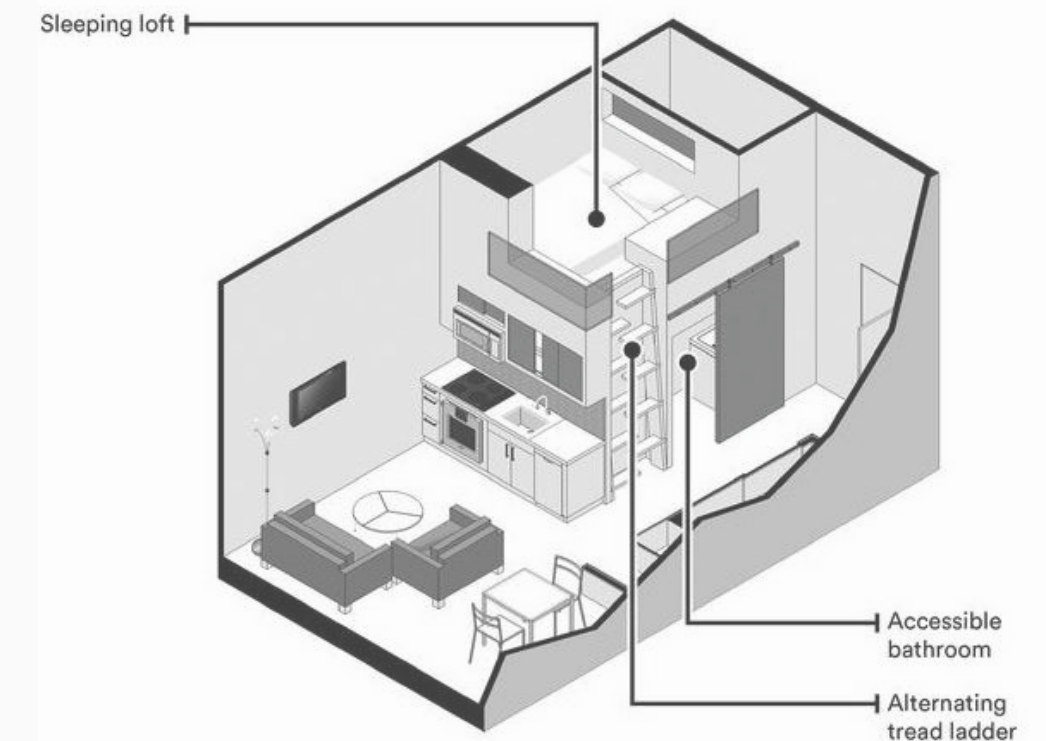
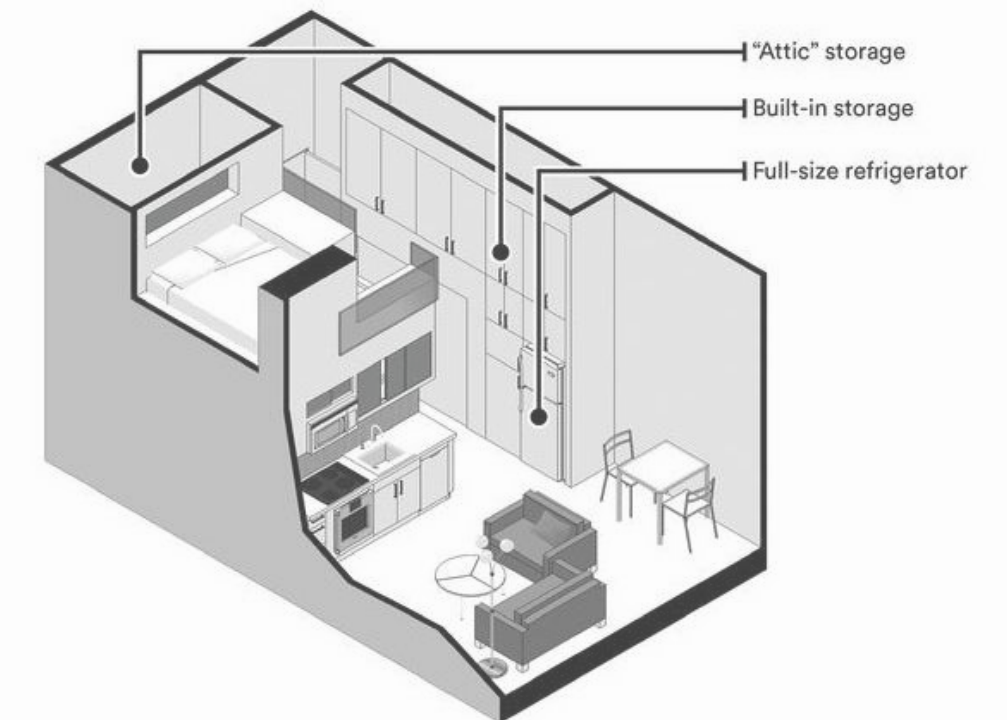



About 8.8 million household in India live in urban slums, a survey conducted by the National Sample Survey Office (NSSO), Ministry of Statistics and Programme Implementation, says .

estimates that a total of 33,510 slums are present in urban India, of which 41 per cent are notified as slums by the concerned municipalities, corporations, local bodies or development authorities.



Maharashtra, which is well known for Dharavi, Asia's largest slum, accounts for 23 per cent of all slums in the country.

With 13.5 per cent of slums, Andhra Pradesh comes second, followed by West Bengal (12 per cent).

According to the findings, as many as 38 per cent of slum households of urban India are estimated to be living in Maharashtra, and 18 per cent in Andhra Pradesh.

“Of the 19,749 non-notified slums estimated to exist in urban India, Maharashtra accounted for about 29 per cent, West Bengal for about 14 per cent, and Gujarat for about 10 per cent,” said the survey of The Hindu.





According to the latest Indian government figures, people in its cities have just 5.5 sq m (59 sq ft) per person.

55% of the country's urban population live, sleep, cook and wash in a space no bigger 5.5 sq m per person.

In the slums of urban India the average living space for per person 2.73 sq m (29.38 sq ft).

the average slum household in India has 4 people

The average size of a slum in India is less than 120 sq ft.



THANK YOU

Hritick Konar  
BSC Interior Designing

---